

RIGHT - OF - WAY									
TRACT NUMBERS									
RODDAGE									

SURVEY DATA
 SURVEY COMPANY:
 FIELD BOOK:
 PAGES:

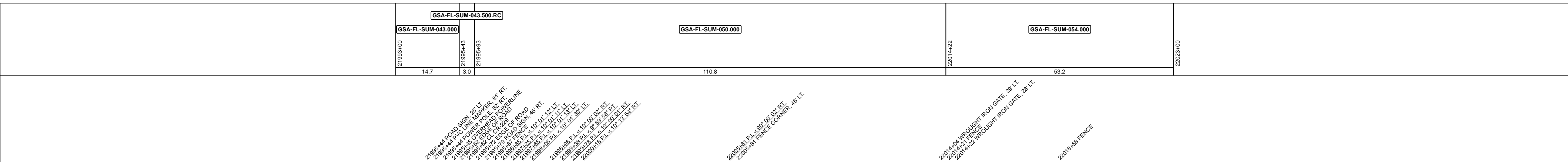

CLASS LOCATION
MINIMUM DEPTH OF COVER

CLASS 2	CLASS 1
3'	4'
231'	1719'

ALIGNMENT DETAIL

PROPOSED PIPELINE
 PROPOSED PERMANENT EASEMENT
 TEMP WORKSPACE
 ADD. TEMP. WORKSPACE
 EASEMENT LINE
 CL STREAM/CREEK/DITCH
 EDGE OF WATER
 CL LEVEE
 FIELD DELINEATED WETLAND
 STREAM/DRAIN/WATERBODY BNDRY
 CL ROAD
 EDGE OF ROAD/PAVEMENT/CURB
 CL CULVERT
 CL RAILROAD
 ACCESS ROAD (PAR/TAR)
 STRUCTURE
 CONTOUR MAJOR (EVERY 10')
 CONTOUR MINOR (EVERY 2')
 PIPELINE MILEPOST
 PIPELINE MILEPOST 10TH
 PROPERTY LINE
 UNDERGROUND WATERLINE
 UNDERGROUND COM. CABLE
 UNDERGROUND POWERLINE
 UNDERGROUND SANITARY SEWER
 OVERHEAD POWERLINE
 OVERHEAD TELEPHONE
 VERIFIED PIPELINE
 FENCE
 TOP / TOE

TRANS. TOWER
 GUY ANCHOR
 HDD ENTRY/EXIT
 FIRE HYDRANT
 UTILITY POLE
 AERIAL MARKER
 ELEC., WATER, SAN. SEWER, GAS
 TELE. & STORM DRAIN MANHOLES

WELL
 SEPTIC
 VALVE
 METER
 SPREAD BREAK

DATE OF AERIAL PHOTOGRAPHY: MARCH 18, 2015 AND BING: FEB. 28, 2011



REFERENCE DRAWING
ENVIRONMENTAL SURVEY DATA

1657-PL-DG-32481	
------------------	--

SENSITIVE AREAS

6a, 6b, 8, 16, 18

PROFILE

SCALE:
 HORIZONTAL: 1" = 200'
 VERTICAL: 1" = 200'

THE LOCATION OF TRENCH PLUGS AND SLOPE BREAKERS ARE INTENDED TO BE USED AS A GUIDELINE ONLY. EXACT LOCATION TO BE DETERMINED IN THE FIELD AS DIRECTED BY THE CHIEF INSPECTOR.

SLOPE BREAKERS/ARROW INDICATES DIRECTION

TRENCH PLUG
 CP TEST STATION
 RECTIFIER
 DECOUPLER

CODE	% SLOPE	TRENCH PLUG SPACING
A	< 5%	NO STRUCTURE
B	5 - 15%	300 FT
C	15 - 30%	200 FT
D	> 30%	100 FT

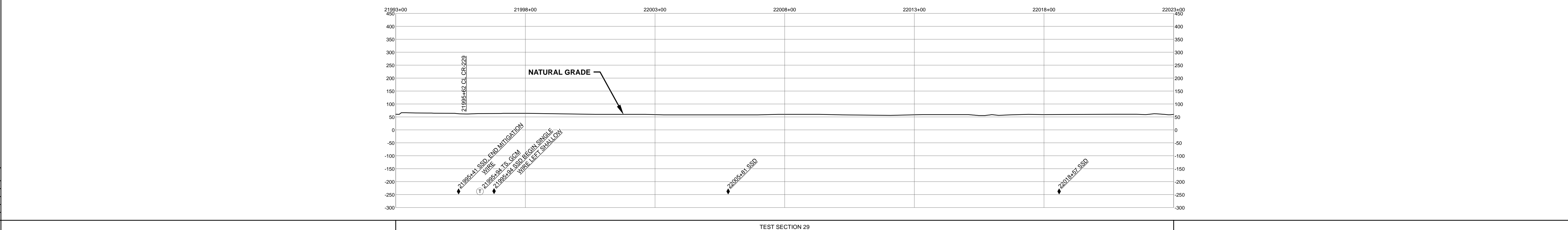

HYDROSTATIC TEST SECTION

DWG. NO.	DESCRIPTION	REV	DRN	DATE	DESCRIPTION	ITEM NO.	DESCRIPTION	QTY
		0		06/29/2015	ISSUED FOR BID	1	36" O.D. x 0.520" W.T., API 5L X70, FBE 16 MILS w/I.D. EPOXY 1.7 MILS	1967 LF
		1		03/14/2016	ISSUED FOR CONSTRUCTION	2	36" O.D. x 0.625" W.T., API 5L X70, FBE 16 MILS w/I.D. EPOXY 1.7 MILS	972 LF
						4	36" O.D. x 0.750" W.T., API 5L X70, FBE 16 MILS, ARO 24 MILS, w/I.D. EPOXY 1.7 MILS	61 LF
						3R	3R ELBOW, HIGH STRENGTH WROUGHT BUTT-WELDED FITTINGS, 36" O.D.	1 EA

REFERENCE DRAWINGS		REVISIONS		MATERIALS		ENGINEERING APPROVALS				SABAL TRAIL PROJECT PROPOSED 36" PIPELINE STA. 21993+00 TO STA. 22023+00 ALIGNMENT SHEET		Sabal Trail TRANSMISSION	
						TITLE		CONSTRUCTION		LOC. SUMTER COUNTY, FLORIDA		YEAR: 2017 SHEET: 423 OF 492 SCALE: 1" = 200' DWG. 1657-PL-DG-70197-423 REV. 1	
						SIGNATURE		DATE					
						DATE		DATE					
						DRAWN BY: GIE		FRS		03/14/2016			
						DRN. DATE: 01/04/2016		FRS		03/14/2016			
						CHECKED BY: GIE		DRS		06/29/2015			
						CHK. DATE:		JC		03/14/2016			