

# REZ-2019-17

# Future Development Map

## QUILLIAN POWELL Rezoning Request

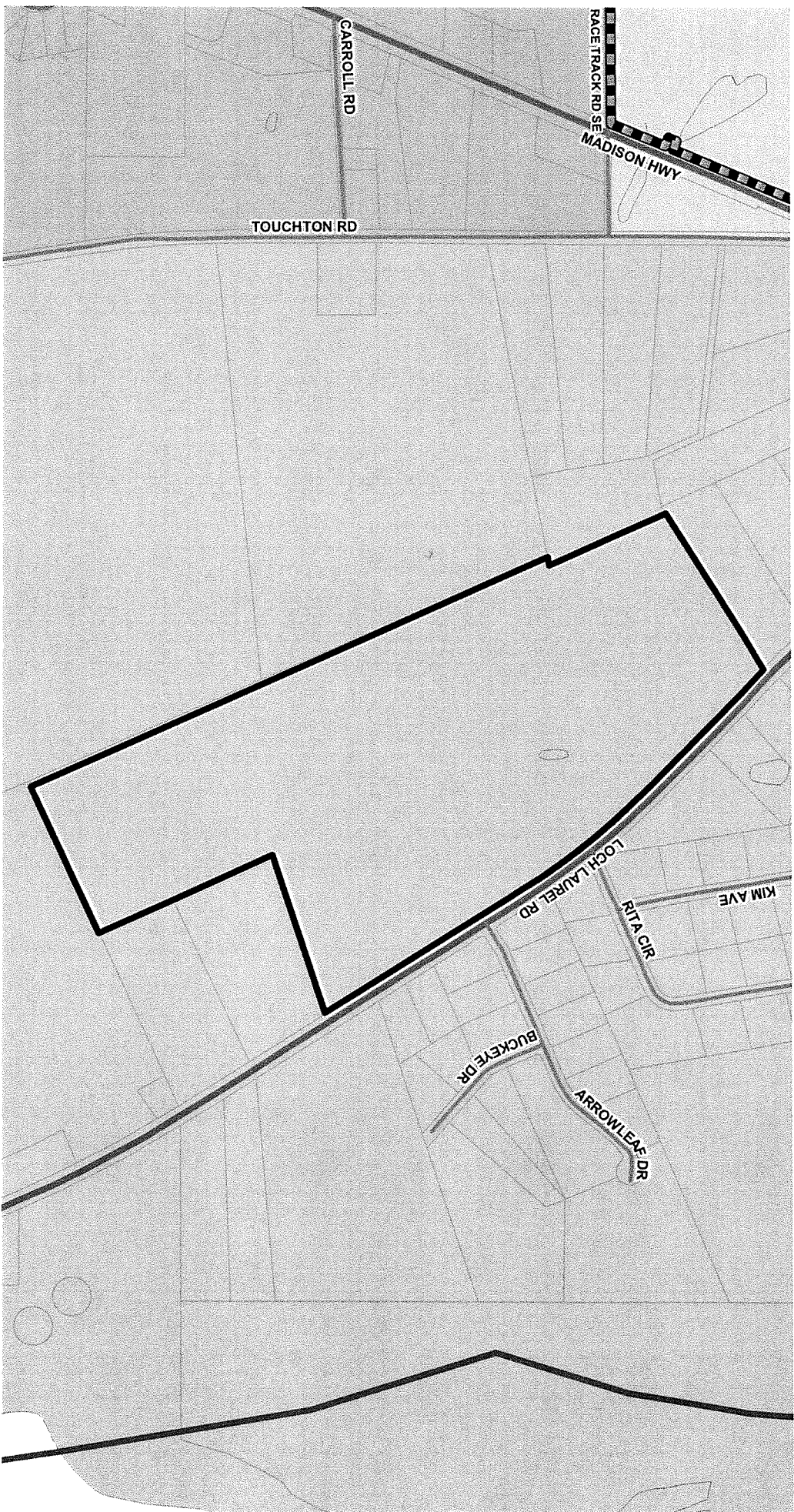

**VALOR**  
VALORIA LOWNDES REGIONAL GEOGRAPHIC INFORMATION SYSTEM  
Visit VALOR on the web at: [WWW.VALORGIS.COM](http://WWW.VALORGIS.COM)

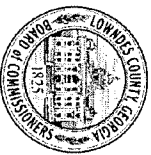

- Roads**
- Functional Classification**
- 1. INTERSTATE
  - 3. OTHER PRINCIPAL ARTERIAL
  - 4. MINOR ARTERIAL
  - 5. MAJOR COLLECTOR
  - 6. MINOR COLLECTOR
  - 7. LOCAL
- Railroads**
- Urban Service Area**
- City Limits
  - Open Water
- Land Use Zones**
- Agriculture / Forestry
  - Community Activity Center
  - Downtown
  - Established Residential
  - Industrial Activity Center
  - Industrial Area
  - Institutional Activity Center
  - Linear Greenpark/Trails
  - Mill Town
  - Moody Activity Zone
  - Neighborhood Activity Center
  - Park/Recreation/Conservation
  - Public / Institutional
  - Regional Activity Center
  - Remerion Neighborhood Village
  - Rural Activity Center
  - Rural Residential
  - Suburban Area
  - Transitional Neighborhood
  - Transportation/Communication/Utilities