

ALL CONSTRUCTION SHALL BE IN ACCORDANCE WITH LOWNDES COUNTY & GDOT STANDARDS AND SPECIFICATIONS

Advanced Engineering Services, LLC

CENTERLINE AND RIGHT OF WAY PLANS

FOR

TWIN LAKES ROAD PAVING IMPROVEMENTS

LOWNDES COUNTY, GEORGIA

PREPARED FOR:

LOWNDES COUNTY BOARD OF COMMISSIONERS



SITE DATA TABLE	
OWNER DEVELOPER	LOWNDES COUNTY BOARD OF COMMISSIONERS 327 NORTH ASHLEY STREET VALDOSTA, GEORGIA 31601 (229) 671-2442 commissioner@lowndescounty.com
PROJECT LOCATION	TWIN LAKES ROAD LAKE PARK, GEORGIA 31636
PROJECT LENGTH	1.71 MILES
DISTURBED AREA	13.7 ACRES



DATE:
OCTOBER 2024

IGTIA # 2300996
PI # 0016280
SGRC - 119

WEST CONSTRUCTION EXIT
GPS LOCATION
LATITUDE: 30.6977° N
LONGITUDE: 83.2398° W

EAST CONSTRUCTION EXIT
GPS LOCATION
LATITUDE: 30.6973° N
LONGITUDE: 83.2117° W



LEVEL II DESIGN PERSONNEL

LEVEL II CERTIFICATION NO.

DATE

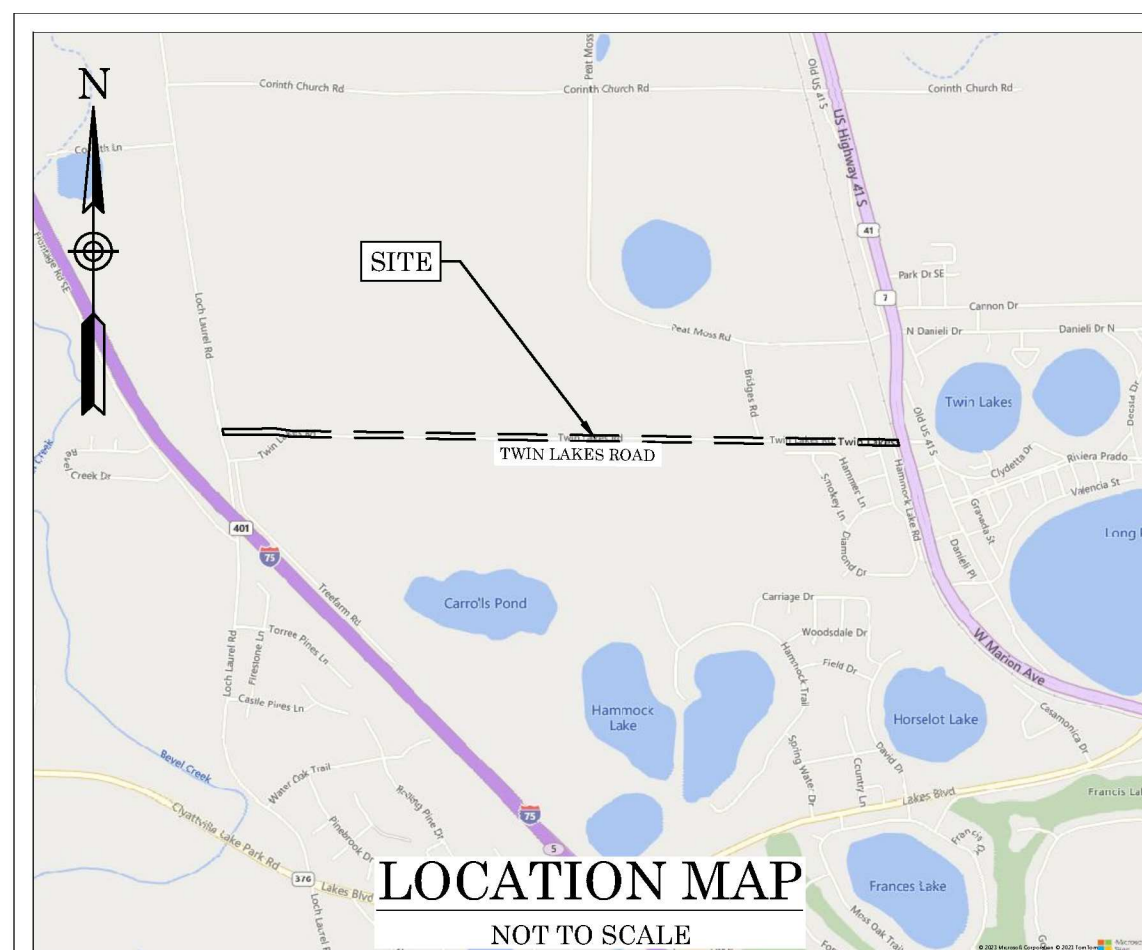

LOCATION MAP
NOT TO SCALE

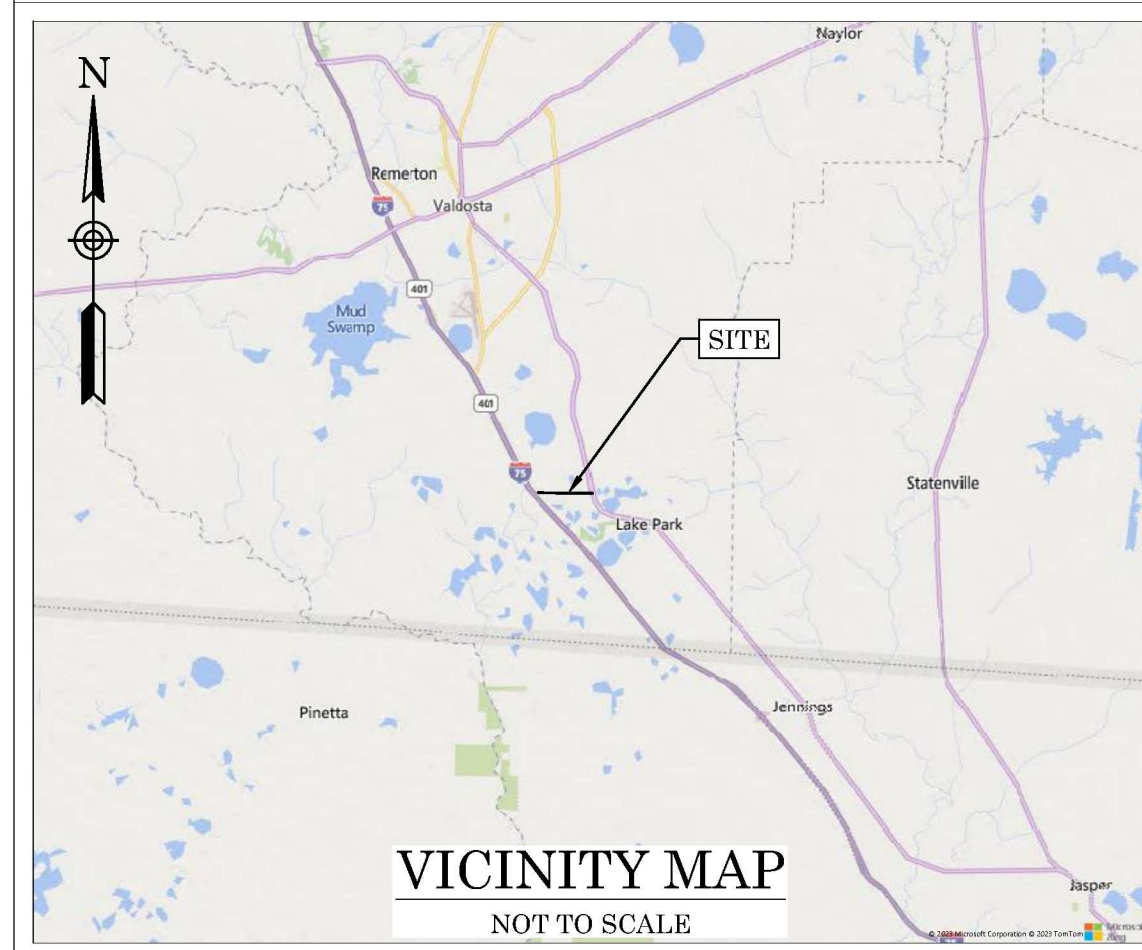

VICINITY MAP
NOT TO SCALE

DATE	REVISIONS
	1. REVISE PARCEL LABELS FOR PARCELS 2 AND 3 TO READ AS TRACTS 1, 2, 3, ETC. VERSES A, B, C, ETC. (EX. PARCEL 2 - TRACT 1 INSTEAD OF PARCEL 2A) ON PLANS AND LINE TABLES
	2. LOCATE EXISTING RESIDENCE STRUCTURE ON PARCEL 20 AND ADD DIMENSION FROM PROPOSED RIGHT-OF-WAY.
	3. SHOW EXISTING DRIVEWAY OFF TWIN LAKES ROAD INTO PARCEL 20.
	4. LOCATE EXISTING WELL HOUSE ON PARCEL 19 AND ADD DIMENSION FROM PROPOSED RIGHT-OF-WAY.

Sheet List Table	
Sheet Number	Sheet Title
C1.0	PROJECT COVER
C2.0	GENERAL NOTES
C3.0	OVERALL SITE MAP
C4.0 - C4.6	EXISTING CONDITIONS & DEMOLITION PLAN
C5.0 - C5.13	ROADWAY PLAN & PROFILE
C6.0 - C6.7	ROADWAY CROSS SECTIONS
C7.0 - C7.6	EROSION, SEDIMENTATION, AND POLLUTION CONTROL PLAN
C8.0 - C8.2	EROSION, SEDIMENTATION, & POLLUTION CONTROL NOTES
C9.0 - C9.1	CONSTRUCTION DETAILS
C10.0	EROSION CONTROL DETAILS

CONTACT INFORMATION

LOWNDES COUNTY
ENGINEERING DEPARTMENT
MIKE FLETCHER, PE
229-671-2424

ADVANCED ENGINEERING SERVICES, LLC
PROJECT MANAGER
MATTHEW INMAN, PE
800-416-8136

LOWNDES COUNTY OFFICIALS

CHAIRMAN: BILL SLAUGHTER
DISTRICT 1: JOYCE EVANS
DISTRICT 2: SCOTT ORENSTEIN
DISTRICT 3: MARK WISENBAKER
DISTRICT 4: DEMARCUS MARSHALL
DISTRICT 5: CLAY GRINER

COUNTY MANAGER: PAIGE DUKES
COUNTY ENGINEER: MIKE FLETCHER, PE

APPROVED: _____
CHERYL H. BREWER TIA RIGHT OF WAY MANAGER DATE _____
LOCATION AND DESIGN APPROVAL DATE: _____

I CERTIFY THAT THE PERMITTEE'S EROSION, SEDIMENTATION AND POLLUTION CONTROL PLAN PROVIDES FOR AN APPROPRIATE AND COMPREHENSIVE SYSTEM OF BEST MANAGEMENT PRACTICES REQUIRED BY THE GEORGIA WATER QUALITY CONTROL ACT AND THE DOCUMENT "MANUAL FOR EROSION AND SEDIMENT CONTROL IN GEORGIA" (MANUAL PUBLISHED BY THE GEORGIA SOIL AND WATER CONSERVATION COMMISSION AS OF JANUARY 1 OF THE YEAR IN WHICH THE LAND-DISTURBING ACTIVITY WAS PERMITTED, PROVIDES FOR THE SAMPLING OF THE RECEIVING WATERS) OR THE SAMPLING OF THE STORMWATER OUTFALLS AND THAT THE DESIGNED SYSTEM OF BEST MANAGEMENT PRACTICES AND SAMPLING METHODS IS EXPECTED TO MEET THE REQUIREMENTS CONTAINED IN THE GENERAL NPDES PERMIT NO. GAR100001.

I CERTIFY UNDER PENALTY OF LAW THAT THIS PLAN WAS PREPARED AFTER A SITE VISIT TO THE LOCATIONS DESCRIBED HEREIN BY MYSELF OR MY AUTHORIZED AGENT, UNDER MY SUPERVISION.

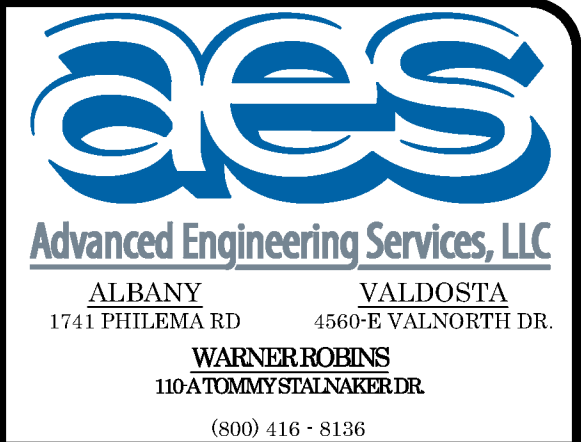

B. Matthew Inman
LEVEL II CERTIFIED DESIGN PROFESSIONAL

CERTIFICATION NUMBER: 0000000855
ISSUED: 06/01/2022 EXPIRES: 06/01/2025

AES PROJECT NUMBER: 61012
DATE OF PLANS: 10/18/2024
REVISIONS:

NO.	DATE	DESCRIPTION
1	-	-
2	-	-
3	-	-
4	-	-
5	-	-
6	-	-
7	-	-
8	-	-
9	-	-
10	-	-

TWIN LAKES ROAD PAVING IMPROVEMENTS
LOWNDES COUNTY BOARD OF COMMISSIONERS
PROJECT COVER

LOWNDES COUNTY, GEORGIA

NOT TO SCALE

SHEET

C1.0 OF 46